

AIRCRAFT PARKING/DOCKING CHART - ICAO

Okęcie TOWER 118.305  
Okęcie GROUND 121.905

WARSAW CHOPIN AIRPORT

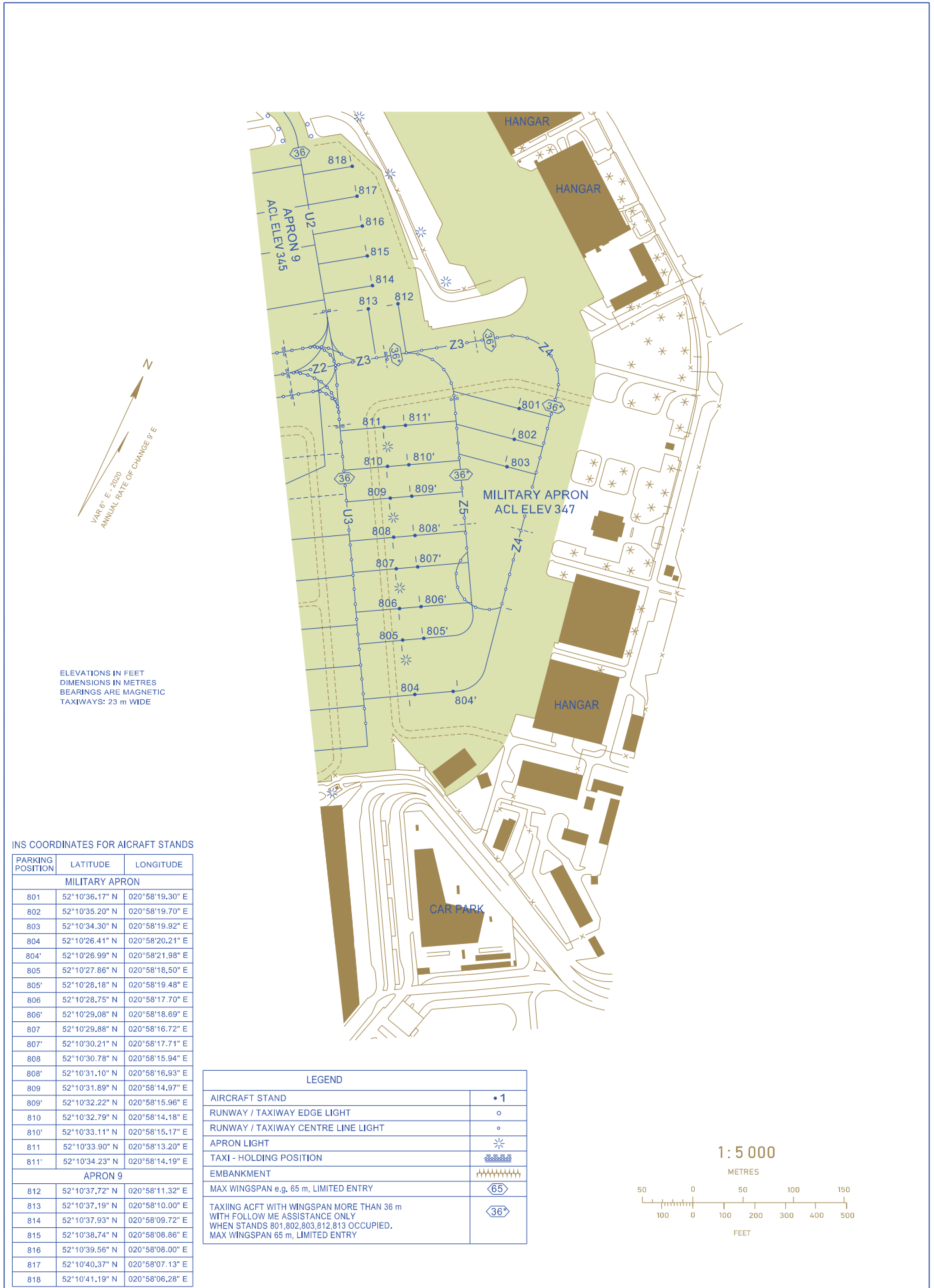

ELEVATIONS IN FEET  
DIMENSIONS IN METRES  
BEARINGS ARE MAGNETIC  
TAXIWAYS: 23 m WIDE

INS COORDINATES FOR AIRCRAFT STANDS

PARKING POSITION	LATITUDE	LONGITUDE
<b>MILITARY APRON</b>		
801	52°10'36.17" N	020°58'19.30" E
802	52°10'35.20" N	020°58'19.70" E
803	52°10'34.30" N	020°58'19.92" E
804	52°10'26.41" N	020°58'20.21" E
804'	52°10'26.99" N	020°58'21.98" E
805	52°10'27.86" N	020°58'18.50" E
805'	52°10'28.18" N	020°58'19.48" E
806	52°10'28.75" N	020°58'17.70" E
806'	52°10'29.08" N	020°58'18.69" E
807	52°10'29.88" N	020°58'16.72" E
807'	52°10'30.21" N	020°58'17.71" E
808	52°10'30.78" N	020°58'15.94" E
808'	52°10'31.10" N	020°58'16.93" E
809	52°10'31.89" N	020°58'14.97" E
809'	52°10'32.22" N	020°58'15.96" E
810	52°10'32.79" N	020°58'14.18" E
810'	52°10'33.11" N	020°58'15.17" E
811	52°10'33.90" N	020°58'13.20" E
811'	52°10'34.23" N	020°58'14.19" E
<b>APRON 9</b>		
812	52°10'37.72" N	020°58'11.32" E
813	52°10'37.19" N	020°58'10.00" E
814	52°10'37.93" N	020°58'09.72" E
815	52°10'38.74" N	020°58'08.86" E
816	52°10'39.56" N	020°58'08.00" E
817	52°10'40.37" N	020°58'07.13" E
818	52°10'41.19" N	020°58'06.28" E

LEGEND	
AIRCRAFT STAND	• 1
RUNWAY / TAXIWAY EDGE LIGHT	○
RUNWAY / TAXIWAY CENTRE LINE LIGHT	◦
APRON LIGHT	✱
TAXI - HOLDING POSITION	⊞
EMBANKMENT	▬▬▬▬▬▬
MAX WINGSPAN e.g. 65 m, LIMITED ENTRY	(65)
TAXIING ACFT WITH WINGSPAN MORE THAN 36 m WITH FOLLOW ME ASSISTANCE ONLY WHEN STANDS 801,802,803,812,813 OCCUPIED. MAX WINGSPAN 65 m, LIMITED ENTRY	(36)

